



KONICA MINOLTA

bizhub 225i/205i

A3 Monochrome Multifunctional Printers

bizhub i-SERIES

RETHINK BUSINESS



225i

BW 22 PPM

205i

BW 20 PPM

Giving Shape to Ideas

CONTROL PANEL

Easy to understand and easy to use.
One-touch buttons for speedy operation.

Get to the Point

Find your way around in moments with an intuitive layout and large buttons. Useful functions such as ID Print and Duplex Copy have been assigned their own hard keys, so there's no need to scroll through menus to find what you need.

Backlit LCD Screen

The five-line, backlit LCD display improve legibility. With clear error indication, illustrated guidance assist you with problem solving, so you can get your machine working again as soon as possible, minimising downtime.



COPY & PRINT

Plenty of useful layout options to keep your documents organised.

Handy Booklets

Easily collate your multi-page documents into a booklet with Booklet Print.



Get Everyone on the Same Page

Print multiple pages onto one sheet with N-up Print. Collate 2 or 4 pages into one.

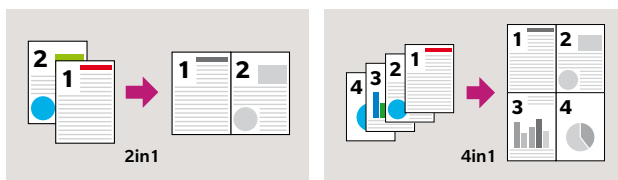

Double Up

The optional Auto Duplex Unit (AD-509) enables Duplex Print and Duplex Copy helps you save paper.

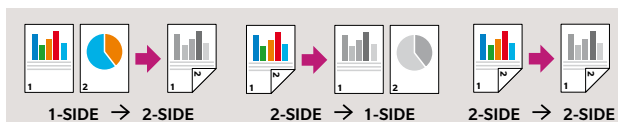

Can I See Your ID?

Combine both sides of small or irregularly shaped documents onto one page with the ID Copy function. With its own designated button on the control panel, you can create scans or copies in moments.

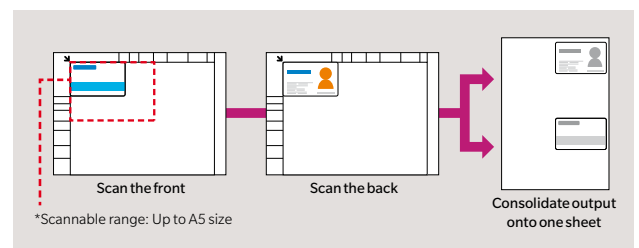

With the Multi ID Copy function, you can scan multiple small documents at once, neatly combining the fronts and backs onto a single sheet. Ideal for business cards.

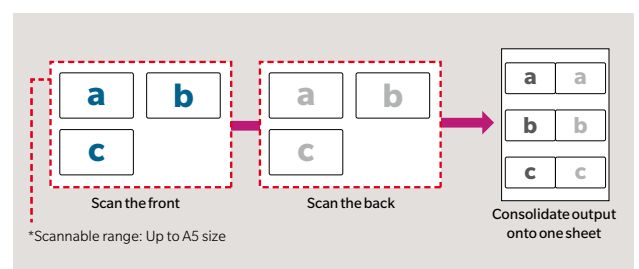

Linux support

Output from a Linux environment is also available.

Supported
Linux OS

Red Hat Enterprise Linux 5 (CUPS Ver1.2.4) x86

Red Hat Enterprise Linux 5 (CUPS Ver1.2.4) AMD64/Intel64/SUSE Linux

Enterprise Desktop 11(CUPS Ver1.1.23) x86

SUSE Linux Enterprise Desktop 11(CUPS Ver1.1.23) AMD64/ Intel64

SCAN & FAX

Digitise your documents in colour and to designated path quickly.

Duplex Scan

The optional Reverse Auto Document Feeder (DF-633) makes double-sided scanning easy. Multi-page, double-sided documents are scanned with the pages in order, keeping your digital files organised and saving you time to re-ordering documents after scanning.

Digitise in Colour

Digitise your documents quickly and easily. Scan up to 20 pages per minute* in full colour, and choose what format you wish to store them in, including JPEG, PDF or TIFF.

*20 ppm is the speed when equipped with optional Reverse Automatic Document Feeder DF-633

Scan to Your Destination

Once your documents are scanned, you can send them to the desired destination directly from your bizhub. Store files straight to a USB storage device via the USB port, send them via e-mail, SMB or to an FTP server.

Sent in Seconds with G3 Fax

With optional Fax Kit (FK-510) and Option Panel (MK-750) you can send faxes in as little as 3 seconds via high-speed G3 faxing. A variety of faxing options are available allowing you to select the ideal format for your document. Select Super Fine image quality for high quality transmission and choose from multiple paper sizes.

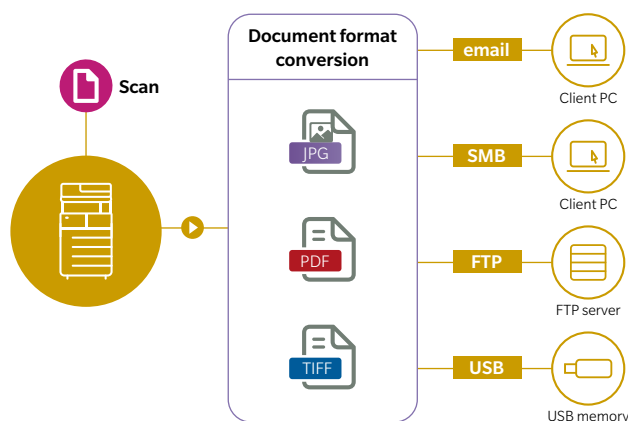

Internet Fax

Save on running costs by using Internet Fax to send your documents via your existing internet connection. Ideal for office spaces where fax is a necessity, but not in use every day.

Requires optional Fax Kit (FK-510) and Option Panel (MK-750).

MOBILE PRINT

No need to waste time transferring documents to your office computer for print. Work on-the-go and stay on-the-go.

Mobile Print for bizhub 205i/225i

Our Mobile Print for bizhub 205i/225i app allows you to print directly from your Android or iOS device. The simple and intuitive app interface makes it easy to select and send documents and photos on your device and send them directly to your bizhub.

*For Android devices download from the Google Play Store. For iOS devices download from the App Store.

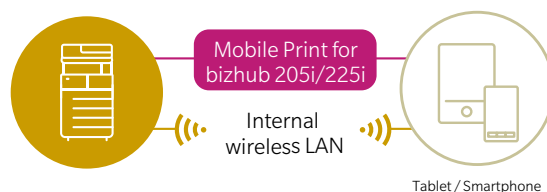

SECURITY

Protect your information and keep your office environment secure.

SMTP Authentication

This security tool enables the sending of documents via e-mail with authentication by an SMTP enabled server. Ideal for smaller offices without a private e-mail server, a connection to an SMTP enabled server allows SSL communication, so e-mails can be sent in a security-conscious state.

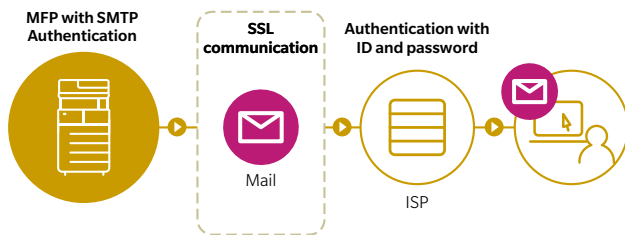

Watermark Your Documents

Ensure your documents are clearly labelled to help prevent them falling into the wrong hands. Choose from a range of watermark options to suit the purpose of your document.

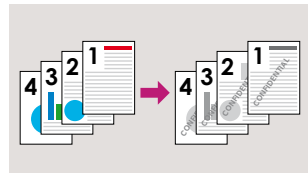

Account Tracking

Enable Account Track on your bizhub to acquire a three-digit account number to use the Copy feature. This prevents unauthorized users from using the bizhub and tracks the volume of copying done by each account.

ACCOUNT NO. :---

Input=10Key

Secure Print

When you enable this option, a password is required at the bizhub itself before a document will print. Set the password via the print driver at your computer, then enter it on your bizhub's control panel to start the print job. This prevents confidential documents from lying around the office or being accessed by unauthorized user.



*Passwords can be set in the range 0000~9999.

bizhub 225i/205i Datasheet

OPTIONS

1 OTHERS

- Document feeder
DF-633
- Original cover
OC-512
- Duplex unit¹
AD-509

¹ bizhub 225i comes with AD-509

2 CONNECTIVITY

- Fax kit
FK-510
- Option panel
MK-750

3 MEDIA INPUT

- Paper tray
PF-507
- Copy desk (large)
DK-706
- Copy desk (medium)
DK-707
- Copy desk (small)
DK-708

LEGEND

- Mandatory option
- Option
- This option can only be installed with the respective option above it



CUSTOMER BENEFITS



Services

Efficient printer fleet management, including automatic consumables delivery, pro-active maintenance and remote setup



Duplex

FINISHING FUNCTIONALITIES

DESCRIPTION

CONNECTIVITY

FK-510 Fax kit	Super G3 fax
MK-750 Option panel	Needed for fax function and scan one-touch destinations

OTHERS

DF-633 Document feeder	Reversing automatic document feeder, capacity 130 originals
OC-512 Original cover	Cover instead of ADF
AD-509 Duplex unit	For duplex printing and copying

MEDIA INPUT

PF-507 Paper tray	250 sheets, B5-A3, 64-90 g/m ²
DK-706 Copy desk (large)	Install with 1x PF-507
DK-707 Copy desk (medium)	Install with 2x PF-507
DK-708 Copy desk (small)	Install with 3x or 4x PF-507

TECHNICAL SPECIFICATIONS

SYSTEM SPECIFICATIONS

System speed A4 225i/205i	Up to 22ppm(24ppm ¹) / up to 20ppm
System speed A3	Up to 8 ppm
Autoduplex speed A4 225i/205i	Up to 15ppm(16ppm ¹) / up to 15ppm
1st page out time A4 225i/205i	6.5 sec or less
Warm-up time	15 sec ² or less
Imaging technology	Laser
Toner technology	Simitri® HD polymerised toner
Panel size/resolution	5 line LCD / 128 x 64
System memory	256 MB
Interface	10/100-Base-T Ethernet; USB 2.0
Network protocols	TCP/IP (IPv4 / IPv6); SMB; LPD; IPP; SNMP; HTTP
Automatic document feeder (optional)	Up to 130 originals; A5-A3; 35-128 g/m ² ; RADF
Printable paper size	A5-A3; customized paper sizes
Printable paper weight	64-157 g/m ²
Paper input capacity (standard/max)	350 sheets / 1,350 sheets
Paper tray input	1x 250 sheets; A5-A3; custom sizes; 64-157 g/m ²
Paper tray input (optional)	1x 250 sheets; B5-A3; custom sizes; 64-90 g/m ² (up to 4x)
Manual bypass	100 sheets; A5-A3; custom sizes; 64-157 g/m ²
Finishing modes (optional)	Group; Sort
Automatic duplexing	A5-A3; 64-90 g/m ²
Output capacity	Up to 250 sheets
Power consumption	220-240 V / 50/60 Hz; Less than 1.30 kW
System dimension (W x D x H) 225i/205i	607 x 570 x 458 mm (without options)
System weight 225i/205i	29.7kg/28.2kg (without options)

PRINTER SPECIFICATIONS

Print resolution	600 x 600 dpi
Page description language	GDI
Operating systems	Windows 7 (32/64); Windows 8.1 (32/64); Windows 10 (32/64); Windows Server 2008 (32/64); Windows Server 2008 R2; Windows Server 2012; Windows Server 2012 R2; Windows Server 2016; Windows Server 2019; Linux

SCANNER SPECIFICATIONS

Scan speed (mono/colour)	150dpi : up to 55/20 ipm in simplex 300dpi : up to 55/8 ipm in simplex
Scan resolution	up to 600 x 600 dpi
Scan modes	Scan-to-eMail; Scan-to-SMB; Scan-to-FTP; Scan-to-USB; TWAIN scan
File formats	JPEG; TIFF; PDF
Scan destinations	32 destinations; 250 speed dials; LDAP support

COPIER SPECIFICATIONS

Copy resolution	600 x 600 dpi
Gradation	256 gradations
Multicopy	1-999
Original format	Max. A3
Magnification	25-400% in 0.1% steps; Auto-zooming

FAX SPECIFICATIONS

Fax standard (optional)	Super G3
Fax transmission	Analogue; i-Fax
Fax resolution	Up to 408 x 392 dpi
Fax compression	MH; MR; MMR; JBIG
Fax modem	Up to 33.6 Kbps
Fax destinations	32 destinations; 250 speed dials

SYSTEM FEATURES

Accounting	Up to 50 user accounts
Software	Web Connection

¹ When feeding from PF-507

² Warm-up time may vary depending on the operating environment and usage

- All specifications refer to A4-size paper of 80 g/m² quality.
- The support and availability of the listed specifications and functionalities varies depending on operating systems, applications and network protocols as well as network and system configurations.
- The stated life expectancy of each consumable is based on specific operating conditions such as page coverage for a particular page size (6% coverage of A4). The actual life of each consumable will vary depending on use and other printing variables including page coverage, page size, media type, continuous or intermittent printing, ambient temperature and humidity.
- Some of the product illustrations contain optional accessories.
- Specifications and accessories are based on the information available at the time of printing and are subject to change without notice.
- Konica Minolta does not warrant that any specifications mentioned will be error-free.
- All brand and product names may be registered trademarks or trademarks of their respective holders and are hereby acknowledged.



Scan Me for more info !

Simitri HD
High Definition Polymers Toner

Simitri
with Biomass



Konica Minolta Business Solutions Asia Pte Ltd

10 Teban Gardens Crescent
Singapore 608903
Tel: +65 6895 8595
Fax: +65 6561 9879
Email: sales@konicaminolta.sg
www.konicaminolta.com

PRESENCE IN THE REGION

BANGLADESH . BHUTAN . BRUNEI . CAMBODIA . INDONESIA . LAOS . MALAYSIA . MAURITIUS . MYANMAR . PHILIPPINES . SINGAPORE . SRI LANKA . THAILAND . VIETNAM

About Konica Minolta Business Solutions Asia

Konica Minolta Business Solutions Asia, based in Singapore, is a wholly owned subsidiary of Konica Minolta Inc., Tokyo, Japan. With its expertise in imaging, data processing and data-based decision making, Konica Minolta creates relevant solutions for its customers and solves issues faced by society.

As a digital workplace solution provider, Konica Minolta helps its clients to identify and unlock the potential digitalisation to help companies reach the next level in the digital maturity of their organisation by rethinking the workplace.

Konica Minolta's Igniting Print Possibilities offering helps printers, converters and brand owners maximize workflow automation to increase efficiency. The company delivers consultancy in all communication matters as well as top-of-the-line production, packaging and label printers. Its finishing devices create print products that stand out and create added value. Konica Minolta has established itself as the production printing market leader for more than a decade (InfoSource).

With its commitment to the Sustainable Development Goals (SDGs), Konica Minolta has pledged to consistently pursue its sustainability and social responsibility goals. The company has been repeatedly recognized for its rich history of social contribution as well as for working towards achieving the SDGs throughout its business and is listed among "2021 Global 100 Most Sustainable Corporations in the World", also having received the highest level in EcoVadis Sustainability Ratings.

Worldwide, the company has over 43,000 employees and is operating in over 150 countries.

Our organisation is certified according to ISO27001, ISO9001, ISO14001 and ISO13485 standards.

